

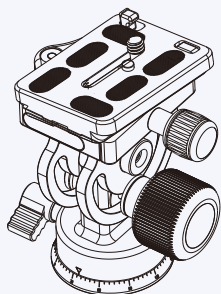

Professional Photographic Equipment

# INSTRUCTIONS

## L-20S Tilt/Pan Head



Zhongshan SIRUI Photographic Equipment Industry CO.,Ltd

Address: The Third Industrial District, Wuguishan Town, Zhongshan City, Guangdong, China  
E-mail: info@sirui-photo.com http://www.sirui-photo.com http://www.zs-sirui.com  
Tel: 0086-760-88997373 Fax: 0086-760-88207062 P.C: 528458  
Service Hotline: 0086-400-8302299

### 1. Know your Tilt/Pan Head

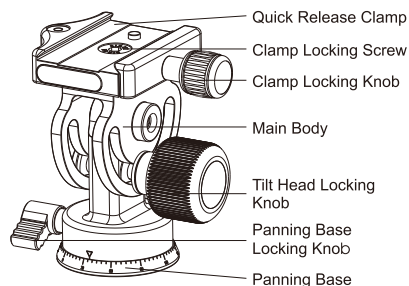

### 2. Attaching Your Tilt Head

Figure 2

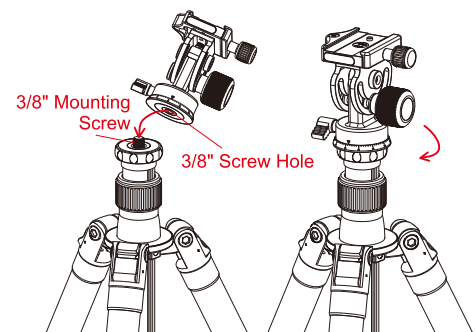

### 3. Using the Tilt Head

Figure 3

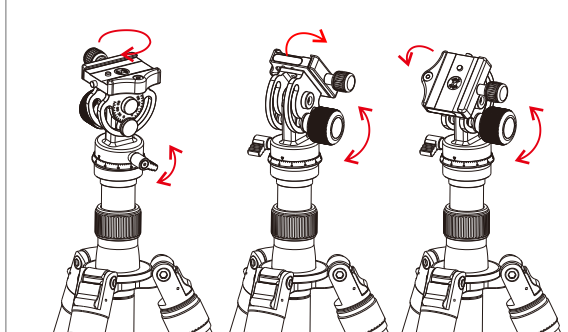

### 4. Quick Release Clamp Direction Adjustment

Figure 4

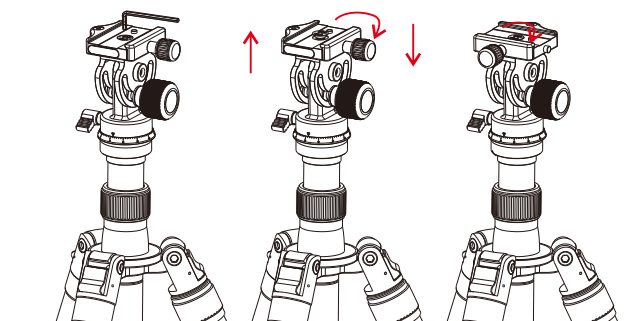

### 5. Know Your Quick Release Clamp and Quick Release Plate

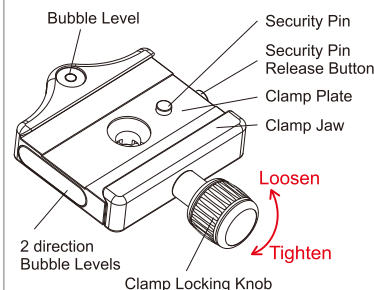

### 6. Attaching and Removing the Quick Release Plate

Figure 6-1

Figure 6-2

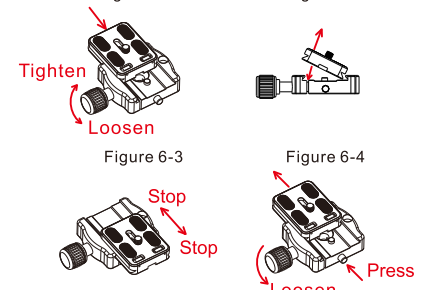

### 1. Know your Tilt/Pan Head

### 2. Attaching the Tilt/Pan Head

- ① To attach the Tilt Head onto the tripod or monopod, you must make sure that the mounting screw of your tripod/monopod is 3/8". If it is 1/4" you will need to get a 3/8" screw or adapter. Many professional tripods/monopods have reversible screws. Please check your tripod/monopod manual for more details.
- ② Lock the Tilt Head Locking Knob and Panning Base Locking Knob by turning it in a clockwise direction. As shown in Figure 2, align the 3/8" thread hole at the bottom of the Tilt Head with the mounting screw on the tripod/monopod. Hold by the base of the Tilt Head and rotate in a clockwise direction until it is locked tightly.

### 3. Using the Tilt/Pan Head

- ① Turn the Panning Base Locking Knob counter-clockwise to unlock, the main body can then rotate 360°.
- ② The Panning Base Locking Knob can be pulled out and repositioned for convenient operation.
- ③ Loosen the Tilt Head Locking Knob, the main body can tilt  $\pm 90^\circ$  to meet different shooting requirements.

### 4. Quick Release Clamp Direction Adjustment

- ① Loosen the Clamp Locking Screw on the platform with the included Allen key.
- ② Lift up the platform, turn 90° in the desired direction, lower the platform and make sure it is seated properly.
- ③ Lock the screw.

### 5. Know Your Quick Release Clamp and Quick Release Plate

### 6. Attaching and Removing the Quick Release Plate

- ① Attaching the QR Plate to Your Camera

Select the QR Plate that matches the base of your camera. To prevent excessive wear to the camera's tripod socket, you should not frequently attach and remove the Quick Release Plate. It is quite common to leave the QR Plate permanently attached to the camera.

The side of the Quick Release Plate with the slide-proof rubber mat must be facing the base of the camera.

Make sure the QR Plate screw aligns with the tripod socket on the bottom of the camera. Position the QR Plate on the camera body and tighten the screw by hand. (If you plan to keep the Quick Release Plate on your camera for a long time or you are using medium or large format cameras, you may want to pop up the plate's red anti-rotation blocks, reposition the plate and tighten the screw by hand first, then tighten with the included allen wrench.)

### ② Attaching the camera with QR Plate onto the Tilt/Pan Head

Slightly loosen the Clamp Locking Knob by turning it counter-clockwise, slide the QR plate laterally into the Quick Release Clamp (Figure 6-1) and tighten the clamp by turning clockwise. Another method is to fully open the Clamp Locking Knob and place the plate in from the top (Figure 6-2). Tighten the knob to lock the camera in place.

### ③ Security Pin on the Quick Release Clamp

There is a safety lock on the top of the Quick Release Clamp that effectively prevents the camera from sliding off of the clamp if it is slightly loosened (Figure 6-3). This allows you to make minor adjustments of the camera position on the Tilt Head without worrying about the camera sliding off of the Quick Release Clamp. This feature is available with all Sirui QR plates. (Warning: While other styles of QR plates can be used on Sirui Tilt Heads, this safety feature may not be available with other brands of QR plates. Even with the Sirui QR Plates, you should hold your camera while loosening the Quick Release Clamp.)

### ④ Removing the Camera with QR Plate from the Tilt/Pan Head

While holding the camera, loosen the Clamp Locking Knob by slightly turning it counter-clock-wise. Push in the Security Pin Release Button and slide the camera off of the Clamp Plate (Figure 6-4). You can also remove the camera by fully opening the clamp and lifting the camera out of the clamp.

L-20S 103/4.1 0.44/0.97 25/55.1

Maximum Load  
Kg/lb  
Height  
mm/inch  
Weight  
Kg/lb

L-20S Data Chart

Specifications are subject to change without notice.