

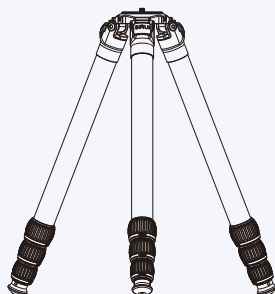

Professional Photographic Equipment

# INSTRUCTIONS

## R-X Series Tripod



Zhongshan SIRUI Photographic Equipment Industry CO.,Ltd

Address: The Third Industrial District, Wuguishan Town, Zhongshan City, Guangdong, China  
E-mail: info@sirui-photo.com http://www.sirui-photo.com http://www.zssirui.com  
Tel: 0086-760-88997373 Fax: 0086-760-88207062 P.C: 528458  
Service Hotline: 0086-400-8302299

### R-X Series Tripod Data Chart

Section	Max Dia mm/inch	Min Dia mm/inch	Min Hgt mm/inch	Max Hgt mm/inch	Max Ext mm/inch	Retracted H mm/inch	Folded H mm/inch	Max Load kg/lb
1	36/1.4	28/1.1	105/4.1	1500/59.1	660/26.0	—	—	25/55.1
2	36/1.4	24/0.9	90/3.5	1500/59.1	550/21.7	—	—	25/55.1
3	40/1.6	28/1.1	90/3.5	1600/63.0	580/22.8	—	—	25/55.1
4	40/1.6	28/1.1	100/3.9	2000/78.7	690/27.2	—	—	30/66.1

### Know your tripod

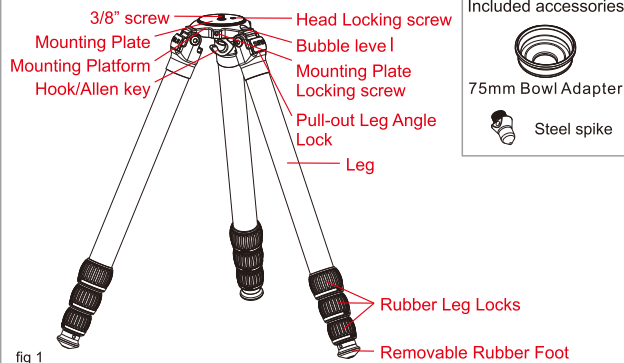

fig 1

### Leg Angle Adjustment

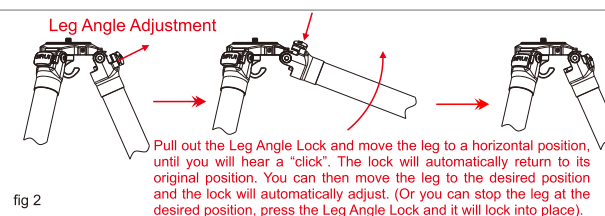

fig 2

### Leg Extension and Closing

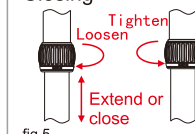

fig 5

The hook is also an Allen key to lock/unlock the Mounting Plate Locking screw.

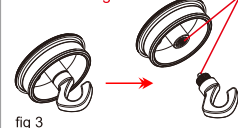

fig 3

### Leg and shim assembly

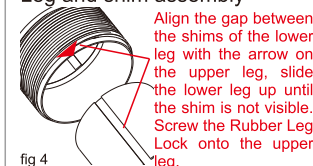

fig 4

### Changing the Rubber Foot/Steel Spike

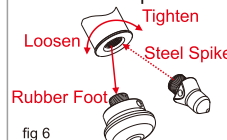

fig 6

### R-X Three Position Leg Angle Adjustment

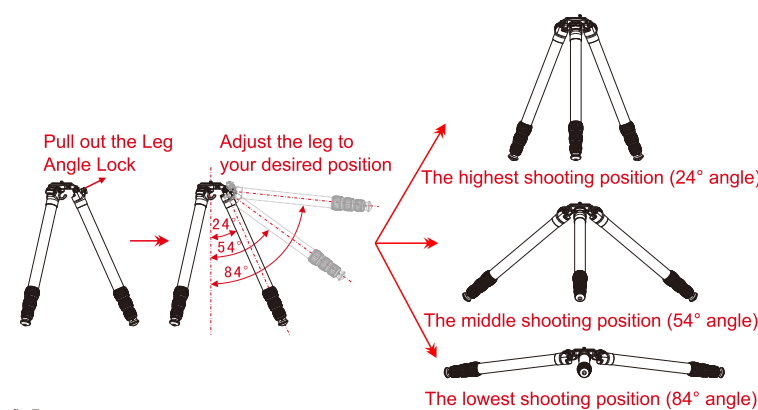

fig 7

### R-X Exchanging the Mounting Plate and 75mm Bowl Adapter

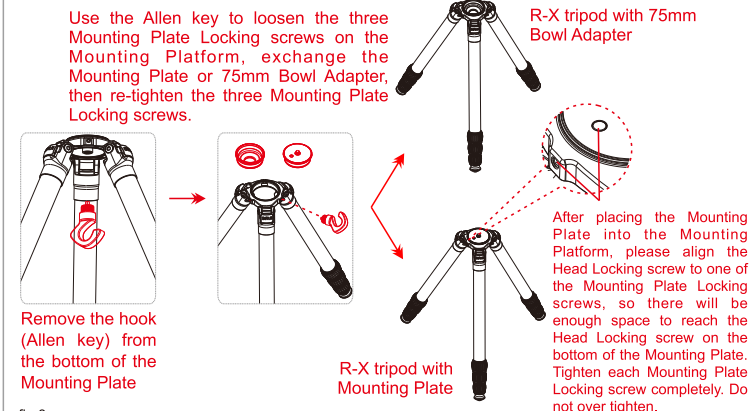

fig 8

#### 1. Knowing your R-X series tripod (shown in fig 1)

#### 2. R-X 3 Leg Angle Positions (shown in fig 7)

The R-X series tripods have 3 different leg angle positions 24°, 54° and 84°, for shooting on uneven terrain.

#### 3. R-X Pull-out Leg Angle Lock with Automatic Locking Mechanism (shown in fig 2)

Pull out the Leg Angle Lock and move the leg to a horizontal position, until you will hear a "click". The lock will automatically return to its original position.

#### 4. Hook can be used as an Allen key (shown in fig 3)

Remove the hook from the bottom of the Mounting Plate, the hook can be used as an Allen key to tighten/loosen the 3 Mounting Plate Locking screws and tighten/loosen the Head Locking screw.

#### 5. R-X Platform and adapter bowl exchange (shown in fig 8)

Remove the hook from the bottom of Mounting Plate, then use the Allen key to loosen the 3 Mounting Plate Locking screws on the Mounting Platform. Remove the Mounting Plate and replace with the 75mm Bowl Adapter. Use the hook (allen key) to lock the 3 Mounting Plate Locking screws (when you replace the Mounting Plate, align the Head Locking screw to one of the Mounting Plate Locking screws, so there will be enough space to reach the Head Locking screw on the bottom of the Mounting Plate). Video heads can be attached to the 3/8" screw; the Head Locking screw secures the video head to the leveling head; the 75mm leveling head can be placed in the 75mm Bowl Adapter.

#### 6. R-X Leg Extension and closing (shown in fig 5)

As shows in fig. 5, twist the legs 1/2 turn in a clockwise direction, then extend the leg to your desired length, and lock the legs from biggest to smallest, when all the legs are closed, lock the leg from small knob to big knob.

#### 7. Rubber foot and Steel spike exchange (shown in fig 6)

#### 8. R-X Assembling the leg and shim (shown in fig 4)

Place the two shims into the corresponding holes in the leg. Then, align the gap between the shims of the lower leg with the arrow on the upper leg and slide the lower leg up until the shim is not visible. Screw the Rubber Leg Lock onto the upper leg.

### Attention:

- Do not exceed the recommended load limit of the head and/or tripod. (Please refer to product specifications).
- Please make sure that the locks are securely tightened when in use.
- This product should not be used in environments that exceed the following conditions (-40 ~ +100°C/-40 ~ +212°F). And, when used in damp, dirty or dusty environments, please clean and dry thoroughly after use, to assure proper functioning in the future. It is not recommended to expose this product to saltwater. If exposed, please clean with mild soap and warm water and towel dry.
- Please keep from high temperatures and direct exposure to bright sunlight for extended periods of time.
- Please do not leave the equipment alone in a public place, which can be an inconvenience or hazard to others.
- To protect your camera gear, please remove it from the tripod/ball head when transporting from place to place.
- Please use a soft towel with mild soap to clean the locking system and gliding parts, when necessary.
- Under most situations, there is no need to lubricate any parts of this product. The addition of most lubricants will gum up the mechanisms and reduce their normal gliding characteristics. Please call or email us if you have any questions or special needs.
- Please keep this product away from all electrical power sources.



### CAUTION

Please remove the camera from the tripod when changing the position of the tripod. Do not place the tripod, with camera attached, over your shoulder or carry the tripod horizontally by the legs. Strong shaking may cause damage of the screw in the mounting plate and/or the camera. Please extend the legs from the biggest tube to smallest tube, close the legs from the smallest tube to biggest tube, to avoid leg joint bushing damage.

Specifications are subject to change without notice.