

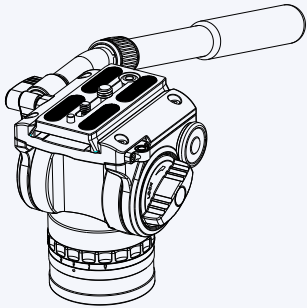

Professional Photographic Equipment

# INSTRUCTIONS

## VH-10X Professional Fluid Video Head



Guangdong SIRUI optical co.,ltd

Address: The Third Industrial District, Wuguishan Town, Zhongshan City, Guangdong, China  
Tel: 0086-760-88997373 Fax: 0086-760-88207062 Service Hotline: 0086-400-8302299  
E-mail: info@sirui-photo.com http://www.sirui.com P.C: 528458

VH-10X 365×145×130		1.2	4	2
Specifications		Weight	Maximum Load	Counterbalanced Weight
mm		kg	kg	kg

VH-10X Data Chart

### Know Your Video Head

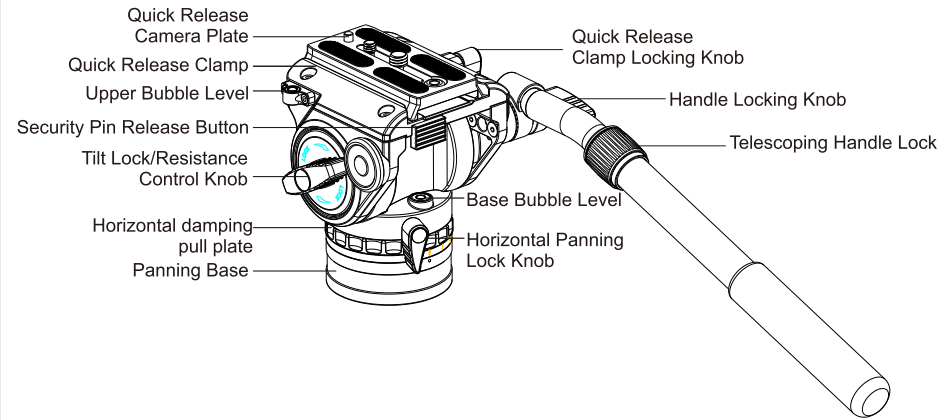

Figure 1

### Attaching and removing the head

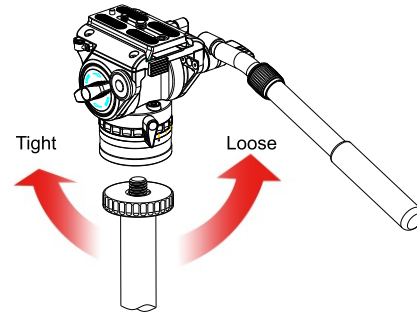

Figure 2

### Attaching or removing the Quick Release Plate from the head

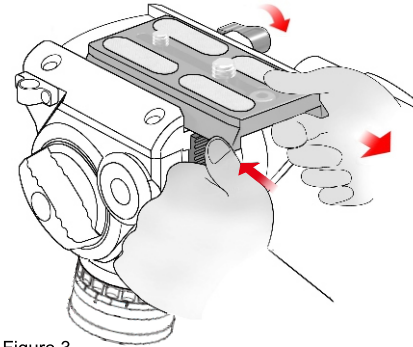

Figure 3

### Attaching or removing the Quick Release Plate from the camera or video camera

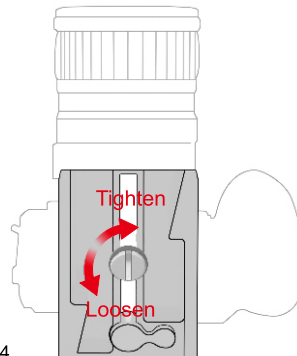

Figure 4

### Attaching the camera or video camera onto the head

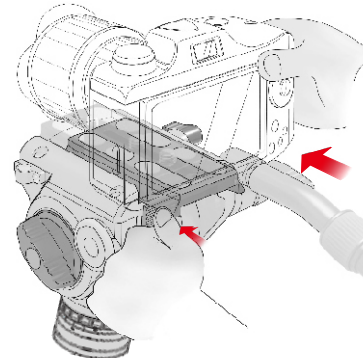

Figure 5

### 1.Precautions:

- ① When attaching the camera or video camera onto the video head, please hold the camera or video camera securely, to prevent accidentally dropping your equipment.
- ② When attaching the video head onto the tripod, please hold the video head securely, to prevent accidentally dropping the head.
- ③ Temperature usage range: -20°C ~ 60°C (-4°F ~ 140°F).
- ④ Tilt angle of the head: -70° ~ +90° .
- ⑤ When the balance is set, if you attach additional accessories, you will need to re-adjust the horizontal balance.

### 2. Basic structure of such Video Head

### 3. Attaching the video head

- ① If the screw on your tripod is UNC1/4", then you need another additional UNC3/8" screw.
- ② As shown in Figure 2, align the 3/8" mounting hole at the bottom of the Video Head with the 3/8" screw on the tripod, and rotate the Video Head in a clockwise direction until it is locked tightly.

### 4. Removing the Quick Release Plate from the head

As shown in Figure 3, loosen the Quick Release Plate Locking Knob in a counter-clockwise direction, press the Security Pin Release Button, then remove the Quick Release Plate from the clamp.

### 5. Attaching the Quick Release Plate onto the Camera

"As shown in Figure 4, screw the 1/4" or 3/8" screw into the tripod socket of your camera by turning in a clockwise direction. Make sure the side of the QR Plate with the rubber plug is in the back, for proper attachment onto the video Head. The QR plate will only fit in one direction. To remove the tripod screw that is not required, pull out the rubber plug on the bottom of the QR plate and slide out the screw. Replace the rubber plug to prevent loss of the remaining screw."

### 6. Attaching the Camera with QR Plate onto the head

As shown in figure 5, press the security button with left hand, then push the camera or video recorder mounted onto the quick release plate into the head as a whole. After that, loose the security button.

Caution: Please make sure that the 'security button' has been returned before loosening the camera or video recorder for fear that the camera or video recorder will fall off the head.



Professional Photographic Equipment

# INSTRUCTIONS

## VH-10X Professional Fluid Video Head

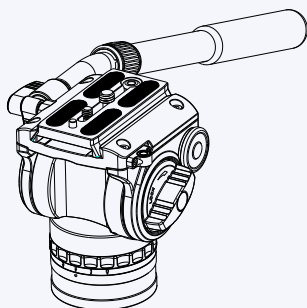

www.sirui.com

Guangdong SIRUI optical co.,ltd  
Address: The Third Industrial District, Wuguishan Town,  
Zhongshan City, Guangdong, China  
P.C: 528458  
Tel: 0086-760-88897373  
Fax: 0086-760-88207062  
Service Hotline: 0086-400-83022299  
E-mail: info@sirui-photo.com  
http://www.sirui.com



### Adjusting the balance of the camera or video camera on the head

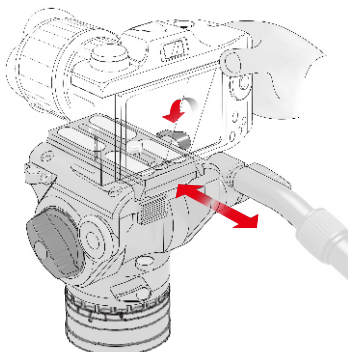

Figure 6

### Use of head during video shooting

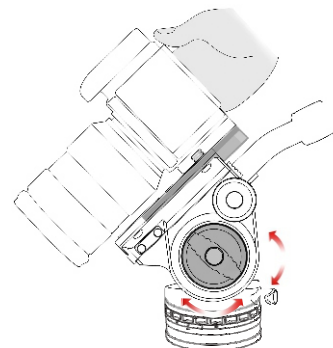

Figure 7

### Removing the camera or video camera from the head

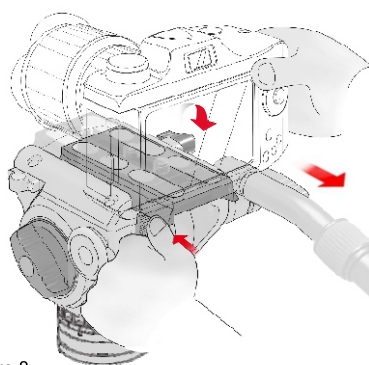

Figure 8

### Adjusting the head before putting it into the storage bag

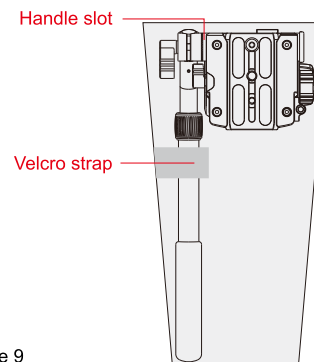

Figure 9

## 7. Balance adjustment on the head with attaching camera

As shown in Figure 6, loosen the Quick Release Clamp Locking Knob, move the camera backwards or forwards until the bubble level on the clamp is centered and lock the Quick Release Clamp Locking Knob. Caution: please make sure the tripod is level by checking the bubble level on the panning base of the video head.

## 8. Using the VH-10X when shooting videos

※The VH-10X has a strong counter-balance system that provides up to 2kg (4.4 lb) of resistance. As shown in Figure 7, by turning the Tilt Lock/Resistance Control Knob you can control the amount of friction needed to make your camera and video camera securely stay at any tilt position. Resistance will also slow movements making it easy to produce smooth, professional looking videos.

※Turn the Tilt Lock/Resistance Control Knob in a clockwise direction to increase resistance and to lock the head in position.

※Turning the Horizontal Panning Lock Knob in a clockwise direction can lock the head in a horizontal position.

※The video head can horizontally pan your camera or video camera 360° and tilt forward 90° and back 70°.

※turn the 'horizontal damping pull plate' in clockwise direction to get different damping grades when turning horizontally.

※According to the actual load of your equipment (and how far away you want to be from the head), you can adjust the length of the handle.

## 9. Removing the camera or video camera from the Video Head

As shown in Figure 8, loosen the Quick Release Clamp Locking Knob, press the Security Pin Release Button, then slide out the camera with QR plate.

## 10. Removing the QR plate from the Camera or Video Camera

As shown in Figure 4, loosen the screw in counter-clockwise direction, and take off the QR plate.

## 11. Storing the QR plate on the Head

As shown in Figure 3, loosen the Quick Release Clamp Locking Knob by turning in a counter-clockwise direction, press the Security Pin Release Button and put the QR plate on the clamp.

## 12. Removing the head from the tripod or monopod

As shown in Figure 2, tighten the Horizontal Panning Lock Knob, to lock the head and prevent it from turning, then turn the whole head in a counter-clockwise direction, until the head is removed from the tripod or monopod.

## 13. Adjusting the head for placement into the storage bag

Before you pack your head, please adjust the head as shown in Figure 9. Loosen the Handle Locking Knob and turn the Handle 180°, so the Handle is pointing forward. Tighten the Handle Locking Knob and place the head into the storage bag. To prevent the head from moving in the bag, please make sure the velcro strip is around the Handle.

Specifications are subject to change without notice.